

Rótula SI

SIL20-T-K-DURBAL - DSIL20-T-K-DURBAL

<https://www.123rolamento.pt/rolamento-mancal/rotula/si/dsil20-t-k-durbal>

SIL20-T-K



female thread:
maintenance free,
according to
DIN ISO 12240-4,
series K



Description: DIN ISO rod end K series. Made of spherical plain bearing DG...PW pressed into rod end body. Sliding combination steel / bronze-PTFE composite.

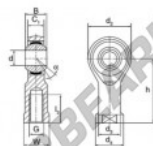

Rod end body:
surface zinc plated

Sliding combination:
steel / bronze-PTFE composite

Inner ring:
bearing steel, hardened, ground and
spherical surface chromium plated

Outer ring:
brass body pressed around, outer race
lined with bronze-PTFE composite

Lubrication:
maintenance free

order number	right hand thread	left hand thread	measurement [mm]						
SIL 20 T/K			d	G	B	C ₁	d ₂	d ₃	d ₄
			20	M 20 x 1,5	25	18,00	50	27,5	34

type	measurement [mm]			load rating C ₅ [N]	weight [kg]
	l ₁ min	W	h		
SI / SIL 20 T/K	33	30	77	14	57,0

CARACTERÍSTICAS DO PRODUTO

Marca	DURBAL
Nº Ean13	3663952489568
Diâmetro interior	20 mm
Diâmetro exterior	50 mm
Espessura	25 mm
Tipo	SI
Peso	420 g
Linha	Rosca esquerda
Lubrificação	sem
Embalagem	1

contato@123rolamento.pt

CRT4 de Lesquin 60 Rue Du Haut De Sainghin 59273 Fretin FRANCE