

## Rótula SI

### SIL28-T-K-DURBAL - SIL28-T-K-DURBAL

<https://www.123rolamento.pt/rolamento-mancal/rotula/si/sil28-t-k-durbal>

#### SIL28-T-K



female thread:  
maintenance free,  
according to  
DIN ISO 12240-4,  
series K



**Description:** DIN ISO rod end K series. Made of spherical plain bearing DG...PW pressed into rod end body. Sliding combination steel / bronze-PTFE composite.

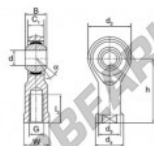

**Rod end body:**  
surface zinc plated

**Sliding combination:**  
steel / bronze-PTFE composite

**Inner ring:**  
bearing steel, hardened, ground and  
spherical surface chromium plated

**Outer ring:**  
brass body pressed around, outer race  
lined with bronze-PTFE composite

**Lubrication:**  
maintenance free

order number		measurement [mm]						
right hand thread	left hand thread	d	G	B	C <sub>1</sub>	d <sub>2</sub>	d <sub>3</sub>	d <sub>4</sub>
	SIL 28 T/K	28	M 27 x 2	35	24,00	66	37,0	46

type	measurement [mm]			d <sub>1</sub> PT	load rating C <sub>10</sub> [N]	weight [kg]
	l <sub>1</sub> min	W	h			
SI / SIL 28 T/K	51	41	103	15	107,0	0,820

## CARACTERÍSTICAS DO PRODUTO

Marca	DURBAL
Nº Ean13	3663952489650
Diâmetro interior	28 mm
Diâmetro interior	1.102" inch
Diâmetro exterior	66 mm
Diâmetro exterior	2.598" inch
Espessura	35 mm
Espessura	1.378" inch
Tipo	SI
Peso	820 g
Linha	Rosca esquerda
Lubrificação	sem
Embalagem	1

[contato@123rolamento.pt](mailto:contato@123rolamento.pt)

CRT4 de Lesquin 60 Rue Du Haut De Sainghin 59273 Fretin FRANCE