

Rótula SI SI35-T-K-DURBAL - SI35-T-K-DURBAL

<https://www.123rolamento.pt/rolamento-mancal/rotula/si/si35-t-k-durbal>

SI35-T-K



female thread:
maintenance free,
according to
DIN ISO 12240-4,
series K



Description: DIN ISO rod end K series. Made of spherical plain bearing DG...PW pressed into rod end body. Sliding combination steel / bronze-PTFE composite.

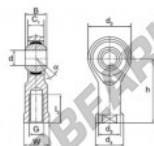

Rod end body:
surface zinc plated

Sliding combination:
steel / bronze-PTFE composite

Inner ring:
bearing steel, hardened, ground and
spherical surface chromium plated

Outer ring:
brass body pressed around, outer race
lined with bronze-PTFE composite

Lubrication:
maintenance free

order number		measurement [mm]						
right hand thread	left hand thread	d	G	B	C ₁	d ₂	d ₃	d ₄
SI 35 TIK		35	M 36 x 2	43	28,00	81	46,0	58

type	measurement [mm]			load rating C ₀ [kN]	weight [kg]
	l ₁ min	W	h		
SI / SIL 35 TIK	56	50	125	16	1,600

CARACTERÍSTICAS DO PRODUTO

Marca	DURBAL
Nº Ean13	3663952489773
Diâmetro interior	35 mm
Diâmetro exterior	81 mm
Espessura	43 mm
Tipo	SI
Peso	1600 g
Linha	Rosca direita
Lubrificação	sem
Embalagem	1
Padrão	Nenhuma norma

contato@123rolamento.pt

CRT4 de Lesquin 60 Rue Du Haut De Sainghin 59273 Fretin FRANCE