

Rótula SA SA30-T-K-DURBAL - SA30-T-K-DURBAL

<https://www.123rolamento.pt/rolamento-mancal/rotula/sa/sa30-t-k-durbal>

SA30-T-K



male thread;
maintenance free,
according to
DIN ISO 12240-4,
series K



Description: DIN ISO rod end K series. Made of spherical plain bearing DG...PW pressed into rod end body. Sliding combination steel / bronze-PTFE composite.

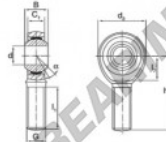

Rod end body:
surface zinc plated

Sliding combination:
steel / bronze-PTFE composite

Inner ring:
bearing steel, hardened, ground and
spherical surface chromium plated

Outer ring:
brass body pressed around, outer race
lined with bronze-PTFE composite

Lubrication:
maintenance free

order number	measurement [mm]				
	d	G	B	C ₁	d ₂
SA 30 T/K	30	M 30 x 2	37	25,00	70

type	measurement [mm]				Tragzahlen C ₁₀ [kN]	weight [kg]
	l ₁ min	t ₂	h	α [°]		
SA / SA1 30 T/K	66	35	110	17	114,0	1,100

CARACTERÍSTICAS DO PRODUTO

Marca	DURBAL
Nº Ean13	3663952490373
Diâmetro interior	30 mm
Diâmetro exterior	70 mm
Espessura	37 mm
Tipo	SA
Peso	1100 g
Linha	Rosca direita
Lubrificação	sem
Embalagem	1

contato@123rolamento.pt

CRT4 de Lesquin 60 Rue Du Haut De Sainghin 59273 Fretin FRANCE