

Rótula SA

BEM25-20-502-DURBAL - BEM25-20-502-DURBAL

<https://www.123rolamento.pt/rolamento-mancal/rotula/sa/bem25-20-502-durbal>

BEM25-20-502



male thread:
maintenance free,
adapter sizes
according to
DIN ISO 12240-4,
series K



**DURBAL® heavy-duty rod ends
with integral spherical
plain bearing**

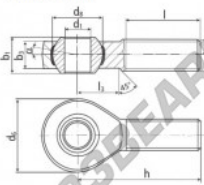

rod end housing:
forged steel, tempered, rolled thread,
surface galvanized, free of Cr-VI

joint ball:
ball bearing steel, hardened and ground,
surface superfinished and chromium
plated

race:
nylon / teflon / glass fibre compound

tolerances:
see page 10

order number		type		type		type		type		type		type	
type	type	type	type	type	type	type	type	type	type	type	type	type	type
BEM 25 -20	-502	25	M 24 x 2	60	42,80	31	22,0						
measurements [mm]		weight		basic load rating		stat.		C		C ₁₀		C ₁₀	
type	h	l	l ₃	α ₁ [°]	α ₂ [°]	[kg]	[N]	[N]	[N]	[N]	[N]	[N]	[N]
BEM 25	94	57	30	15,0	10,0	0,630	45350	118600					

CARACTERÍSTICAS DO PRODUTO

Marca	DURBAL
Nº Ean13	3663952507958
Diâmetro interior	25 mm
Diâmetro exterior	60 mm
Espessura	31 mm
Tipo	SA
Peso	630 g
Linha	Rosca esquerda
Lubrificação	sem
Embalagem	1

contato@123rolamento.pt

CRT4 de Lesquin 60 Rue Du Haut De Sainghin 59273 Fretin FRANCE