

Rótula SI BEF22-20-502-DURBAL - BEF22-20-502-DURBAL

<https://www.123rolamento.pt/rolamento-mancal/rotula/si/bef22-20-502-durbal>

BEF22-20-502



rod end housing:
forged steel, tempered, surface galvanized, free of Cr-VI

joint ball:
ball bearing steel, hardened and ground, surface superfinished and chromium plated

race:
nylon / teflon / glass fibre compound

tolerances:
see page 10

DURBAL® heavy-duty rod ends with integral spherical plain bearing

female thread:
maintenance free, adapter sizes according to DIN ISO 12240-4, series K, thread according to ISO 8139

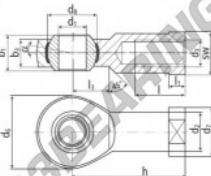

order number		measurements [mm]										
type	right-hand thread	left-hand thread	d ₁	d ₂	d ₃	d ₄	d ₅	d ₆	d ₇	d ₈	b ₁	b ₂
BEF 22	-20	-502	22	30,0	M 22 x 1,5	54	38	38,05	28	20,0		
measurements [mm]			weight					basic load rating				
type	h	l	l ₁	l ₂	SW	α ₁ ¹ [°]	α ₂ ² [°]	(kg)	dyn. C [N]	stat. C ₀ [N]	C ₀ [N]	C ₀ [N]
BEF 22	84	37	12,0	26	32	15,5	10,0	0,520	38230	95600		

CARACTERÍSTICAS DO PRODUTO

Marca	DURBAL
Nº Ean13	3663952508221
Diâmetro interior	22 mm
Diâmetro exterior	54 mm
Espessura	28 mm
Tipo	SI
Peso	520 g
Linha	Rosca esquerda
Lubrificação	sem
Embalagem	1

contato@123rolamento.pt

CRT4 de Lesquin 60 Rue Du Haut De Sainghin 59273 Fretin FRANCE